

ROOTHY: GOING TROPPO OVER A 79 CRUISER!

# CAMPER TRAILER AUSTRALIA

ISSUE 95 DECEMBER 2015 \$8.95 inc GST

## Borgy's outback CHALLENGE!

**10**  
BEST SPOTS  
IN THE TERRITORY

//////////  
FINDING THE BEST CAMPING IN FAR-WEST NEW SOUTH WALES!

**TESTED**

> ULTIMATE XPLOR GT

> LIFESTYLE ELITE BREAKAWAY

> SOUTHERN LAND PT 12

← **FIXING A BUSTED TROOPY!**

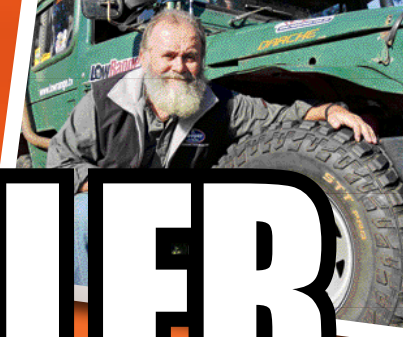

BAUER  
MEDIA GROUP

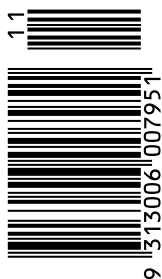



# DESERT READY

BORGY TACKLES OVER 2500KM OF OUTBACK TRAVEL TO FIND OUT IF THE ULTIMATE XPLOR GT LIVES UP TO ITS NAME. WORDS MICHAEL BORG PICS MATT FEHLBERG





**CLOCKWISE FROM TOP LEFT:** Camping off the ground helps on chilly desert nights; The 570mm clearance served Borgy well; The stair legs are adjustable; Independent trailing arm suspension makes it comfortable to tow; Towing aerodynamics reveal its seafaring influence; The D035 coupling is perfect for a serious offroad machine.

## MEASURING UP

### HITS

- > Plenty of organised storage
- > Lightweight yet very solid construction
- > Excellent ground clearance

### MISSES

- > Stabiliser legs are a bit fiddly
- > Limited internal living space
- > Awkward access to fridge when not set up

I'm going to kick this yarn off by saying I've got a tremendous amount of respect for any manufacturer that really backs its brand; I mean really believes in its capabilities and isn't afraid to put it out there for all to see. I say this because there are literally hundreds of different makes and models available to choose from, yet only one manufacturer dares to call itself the Ultimate! That's a pretty big call but, not surprisingly, these guys back it up with confidence and customer service by the bucket-load. So naturally, when the opportunity came to take one of these bad boys out for a test run, it was a no-brainer for me.

The guys at Ultimate Off-Road Campers pride themselves on building a tough camper that's ready to cross the country the day you buy it. So I figured a simple overnight test run wasn't going to cut it for this one. Nope, a more fitting setting to find out what really makes this camper trailer the ultimate would have to be a few weeks tackling the best of outback New South Wales.

### FIRST IMPRESSIONS

If you're new to the scene and aren't familiar with the Ultimate brand, you'll notice its campers look like no other on the market. That's because the origins and style of these campers are straight from the boat building industry. That might sound funny at first, but the boat industry brought a lot more benefits

**“It's not easy for me to say this, but this camper is more capable than my 4WD!”**

to these offroad camper trailers than you would realise. First of all, they are made from fibreglass, which means they are nice and light with a Tare weight of just 850kg. But as light as they are, you can tell they're still a solid reliable unit. I mean, I'm a good 110kg and I wouldn't hesitate for a second to climb all over this thing. In fact, even the handles on the front storage box will take your weight if you ever needed to climb up there!

The whole camper just oozes quality, in my opinion, and it was evident from the second I stepped inside.

### SETTING UP

If there are two things that make a particular camper trailer a pleasure to use, it's simplicity and convenience or, more specifically, a simple setup with a convenient layout. Now I'm going to be honest here, when I first picked up the Xplor GT and got given a quick run through on how to set everything up, I drove off thinking, “geez that seems a bit tricky



for a camper trailer in this price range”.

But, I tell you what, that supposedly tricky setup turned out to be one of the simplest tents I've used so far. The main lid flips over as easy as pie, thanks to strut assistance and a well-positioned adjustable support/guidance pole. Then it's just a matter of clipping four pre-adjusted internal poles in place and repositioning the lounge's cushions.

What I wasn't a big fan of, however, is that, unlike most other hard or softfloor campers, you also have to set the bed up every time you unpack. Admittedly it's only as hard as popping the mattresses in place and throwing your blankets on, but these little things all add up on big trips. That being said, it took me less than six minutes from the time I rolled into camp and set up the camper to crack a beer open – not too shabby.

The only other niggling complaint I have is that the new stabiliser leg design can get a bit annoying on uneven or rocky ground – the pre-drilled pin holes just don't offer as much adjustment as I'd like.



The camper you want is now easier to find

### LET'S TALK LAYOUT

Layout-wise, the Xplor GT ticks plenty of positive boxes. You'll find most features and accessories are nice and easy to reach, although you'll have to crawl through a half door and stretch across the other side of the camper to access the fridge if you're mid-way through your journey.

The internal sink and stove are at a comfortable height, with plenty of bench space, thanks to a second full-length overhead shelf. Plus, all the gauges and electrical knick-knacks are right there at your fingertips, too. The kitchen's layout is really functional, and it's easy to see that it has been tweaked numerous times over the years to get it to this level of simplicity.

It's clear that these campers are a purpose-built, two-person tourer. If you add another person to the mix, things will get a bit squeezey. In saying that, there's plenty of space around the lounge and dining table for two and no shortage of undercover space with the awning attached, so it really does work well.



## REVIEW



## CTA RATING

### 1. FIT FOR INTENDED PURPOSE

★★★★★★★★★★★★

### 2. INNOVATION

★★★★★★★★★★★★

### 3. SELF-SUFFICIENCY

★★★★★★★★★★★★

### 4. QUALITY OF FINISH

★★★★★★★★★★★★

### 5. BUILD QUALITY

★★★★★★★★★★★★

### 6. OFFROAD-ABILITY

★★★★★★★★★★★★

### 7. COMFORTS

★★★★★★★★★★★★

### 8. EASE OF USE

★★★★★★★★★★★★

### 9. VALUE FOR MONEY

★★★★★★★★★★★★

### 10. X-FACTOR

★★★★★★★★★★★★



**CLOCKWISE FROM RIGHT:** The Truma hot water system is found in the storage nosecone; Outback New South Wales proved no challenge for the established offroad performer; The Manager30 battery management system with 12V DC-DC charger keeps your power supply in top condition when you're touring off the grid.



## CTA SPECS

ULTIMATE  
XPLOR GT

### > TRAILER

**Tare** 850kg  
**ATM** 1300kg  
**Suspension** Independent trailing arm  
**Brakes** Electric offroad drum  
**Coupling** Hitchmaster D035  
**Chassis** High tensile DuraGal  
**Drawbar** High tensile DuraGal  
**Body** Fibreglass and carbon fibre  
**Wheel/tyre** 17in Speedy rims and Cooper ST Max tyres, or to match  
**Style** Side-fold hardfloor

### > DIMENSIONS

**Body size** 2000x2000mm  
**Length (hitch to tail lights)** 4250mm  
**Tent size** 4000x2000mm

### > ACCESSORIES

**Gas cylinders** 2x 3.8kg holders  
**Water** 110L  
**Cooktop** Two-burner Smev internal  
**Kitchen** Laminate  
**Battery** 2x110Ah plus Redarc Manager30 management system batt

### > PRICE AS SHOWN

\$60,925

### > ENQUIRIES

To enquire about this camper, visit [www.campertraileraustralia.com.au/spec](http://www.campertraileraustralia.com.au/spec) or phone (02) 8315 0760

### > CAMPERTRAILERAUSTRALIA.COM.AU

> More pictures  
> Specs to compare

## TOUGH TESTING

There's just no other way to put it, this camper is one tough and capable bit of kit. After punting up and down several rugged old goat tracks, scrambling over dozens of rocky trails, and tackling a few of those larger boulders, it was actually slightly more top heavy than I thought it would be. But compared to anything else I've towed in its class, it's a very strong all-round performer. In fact, it's not easy for me to say this, but this camper is more capable than my 4WD! I know, I know – I should have guessed that in the beginning, eh? Maybe I let a bit of Troopy-loving pride take over!

But let's have a think about this for a second – it's got 570mm worth of ground clearance, along with a 32° departure angle and an 18° ramp over angle, which are darn fine specs in anybody's books. Plus, it's lightweight and surprisingly nimble. Add in an extremely strong

and low maintenance hand-moulded composite structure and a chassis fabricated from high tensile DuraGal steel and you get one tough, not to mention very capable, bit of kit.

## FEATURE PACKED

So we've established the Xplor GT will go anywhere you need it to, but let's take a closer look at a few of the creature comforts, shall we? First up, I'll start by saying it's got everything you'll need to tour pretty much anywhere in Australia. That's right – it's basically a turn-key go-anywhere deal with these guys. But what really impressed me is the thought that's gone into choosing the right features and accessories for the job. For example, the Trauma hot water system is up there with the easiest in the industry to use, and the external shower setup is dead-set as simple as plugging in the hose to the outlet

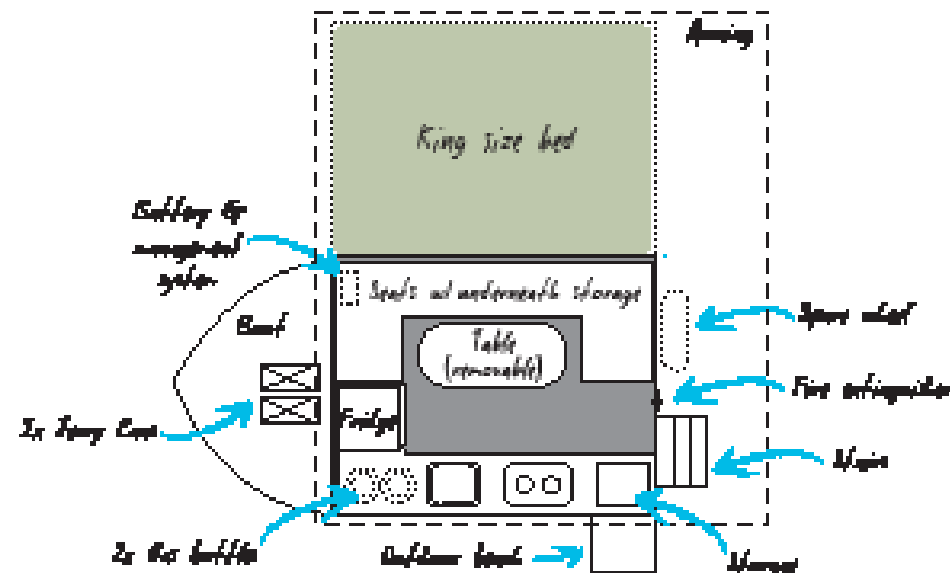

The camper you want is now easier to find



and flicking the electric water pump on; 30 seconds later and you'll be singing The Beatles with nothing but a shower cap on!

Electrically, it's sporting the best of the best with twin 110Ah AGM deep-cycle batteries, along with a Redarc 30A battery management system complete with an internal monitoring panel. There's also a top-notch audio system to help you out with those Beatles tunes, along with two 15A mains power inlets and two dual outlets, and several well-positioned LED lights inside and out. Oh, and there are



four 12V outlets and two USB ports inside, too.

## THE VERDICT

It's pretty simple really – if you want the capability to explore all the little nooks and

**CLOCKWISE FROM TOP:** The immaculate interior is easy to clean; Access to the large bed is via the L-shaped lounge; Indoor dining gives you more options when the weather turns bad.



## REVIEW



**ABOVE LEFT:** A privacy curtain creates a formal bedroom. **ABOVE RIGHT:** A steaming hot shower is simply a matter of plugging in the hose and flicking a switch.



crannies of this beautiful country of ours, but you don't want to sacrifice comfort, the Xplor GT really is, well, the ultimate! It's got the best of the best features stacked into one uniquely tough, aerodynamic design that, if I'm quite honest, is actually very hard to fault.

Over the course of this trip, we clocked up around 3000km and the camper behaved

flawlessly both on and off the tracks. In fact, I'd go as far as saying it's one of the easiest, most functional and capable units I've ever put to the test.

So if you're after a go-anywhere two-person tourer, the Xplor GT from Ultimate Campers gets two thumbs up and a big tick from me. **CTA**

## e-go Caravan Movers - the new must-have accessory for Aussie vans and trailers



**2 YEAR WARRANTY**  
NO QUIBBLE

Tired of moving your van by muscle power?

Space at home too tight to tuck it away?

Or maybe you just don't like reversing?

**Purple Line e-go caravan movers are the answer!**

**Upgrade to safe, simple push-button manoeuvring and hitching with e-go electric movers from Purple Line**



CTG-HH-5185679-OS-095-XCC

See Purple Line's complete range of clever caravan gear at [www.purpleline.com.au](http://www.purpleline.com.au) • Phone (03) 9588 2959



**e-go TITANIUM** from \$1299 + fitting • **e-go PLATINUM** from \$1699 + fitting